

5. ASSEMBLY SHOULD BE SHIPPED WITH 1/4-20 X 1", HHCS, HX, GR5, PL BOLTS WITH LOCK WASHERS AND FLAT WASHERS.

REVISIONS				
ZONE	REV.	DESCRIPTION	DRAWN BY	DATE
	A	INITIAL RELEASE	C WALKER	3/3/2025

AND 1/2" THREADED ROD
(RECOMMENDED)

SAMPLE TABLE(SEE NOTES):

LCD SIZE	DIMENSION AA	
	INCHES	mm
LCD-104	16.875	429
LCD-105	17.875	454
LCD-106	18.875	479
LCD-107	19.875	505

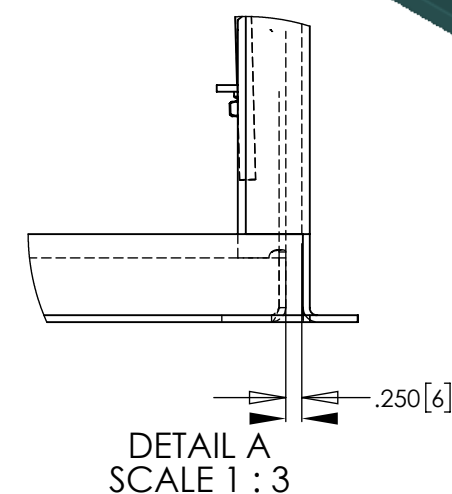
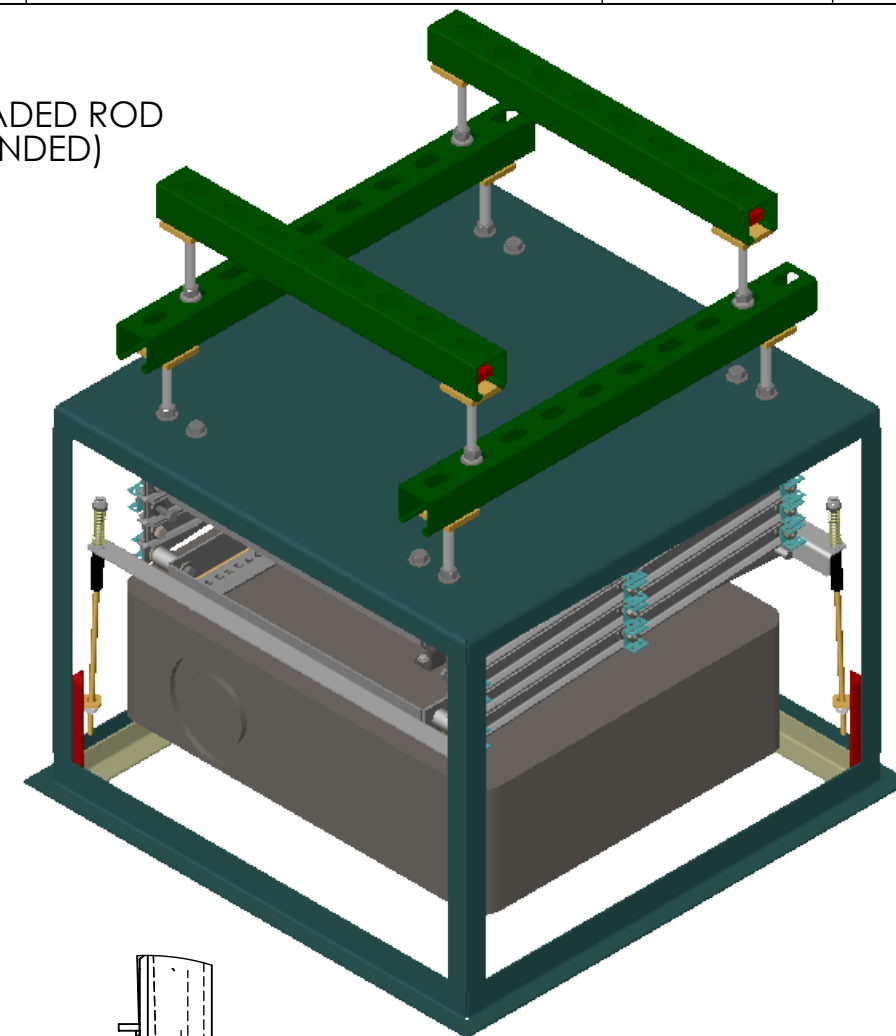

UNLESS OTHERWISE SPECIFIED:
DIMENSIONS ARE IN INCHES
TOLERANCES:
 .XX = ± .020
 .XXX = ± .010
 .XXXX = ± .0050
 ANGLE: ± .5°

INTERPRET DRAWING PER Y14.100.
DIMENSIONS AND TOLERANCES
ARE IN ACCORDANCE WITH
ASME Y14.5 - 2009.

THIRD ANGLE PROJECTION



DO NOT SCALE DRAWING

DRAWN BY

C WALKER

MATERIAL

FINISH

PROPRIETARY AND CONFIDENTIAL

THE INFORMATION CONTAINED IN THIS DRAWING IS THE SOLE PROPERTY OF DISPLAY DEVICES, INC. ANY REPRODUCTION IN PART OR AS A WHOLE WITHOUT THE WRITTEN PERMISSION OF DISPLAY DEVICES, INC IS PROHIBITED.

DISPLAY DEVICES, INC
GOLDEN, CO

TITLE:

LCD, OPT3L, 2'X2'

SIZE

DWG. NO.	
----------	--

3. NO.
SAMPLE

REV

A

SCALE: 1:7

SHEET 1 OF 1